

BrisSnap 2.0



No Leakages by
Screws

Non Pierced Roof
Finishing

PRODUCT OVERVIEW

BriSnap 2.0 — Bold Design, Leak-Free

BriSnap 2.0 features a concealed fixing system that eliminates roof punctures, ensuring a sleek finish with no screw-related leakages. Its deep 38 mm rib and 3 fluted pans make it reliable for longer spans and wider cover applications.

Key Benefits:

- ✓ Leak-free concealed fixing system (no puncture by screws)
- ✓ Deep rib (38 mm) with 3 fluted pans for strength
- ✓ Excellent water discharge capacity
- ✓ Wider cover for efficient installation
- ✓ Modern, seamless roof appearance

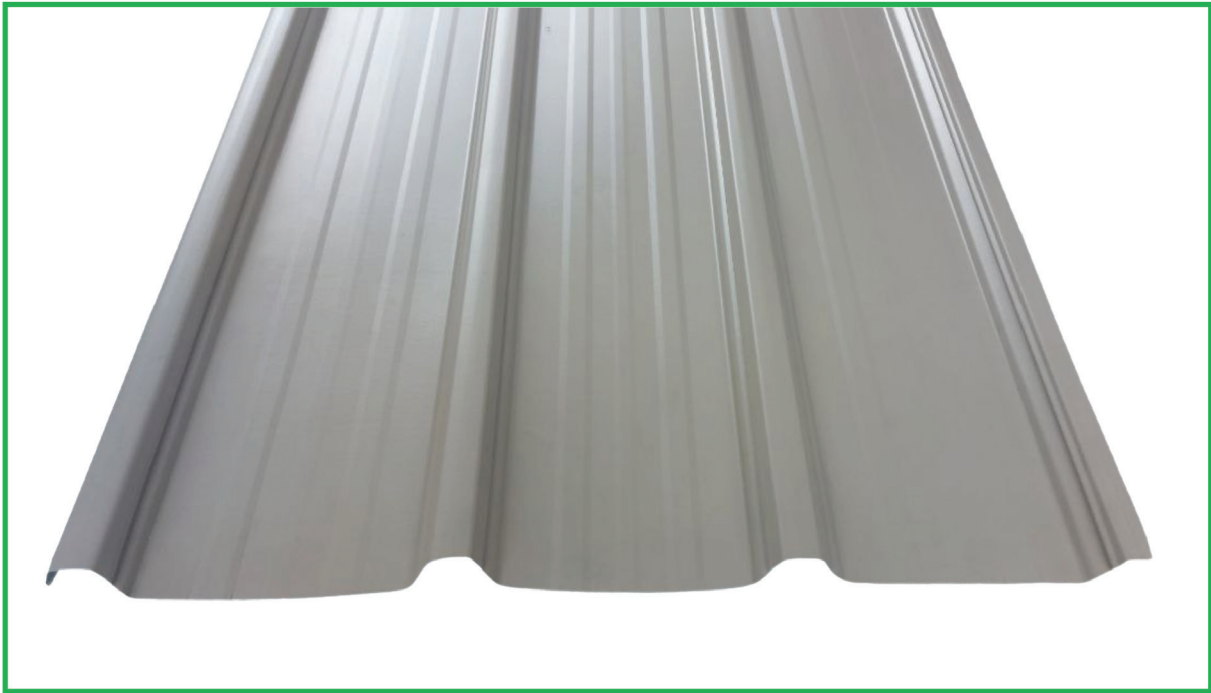

*Photo shown is for illustrative purposes only

FOR BRISNAP ROOFING AND CLADDING

Profile

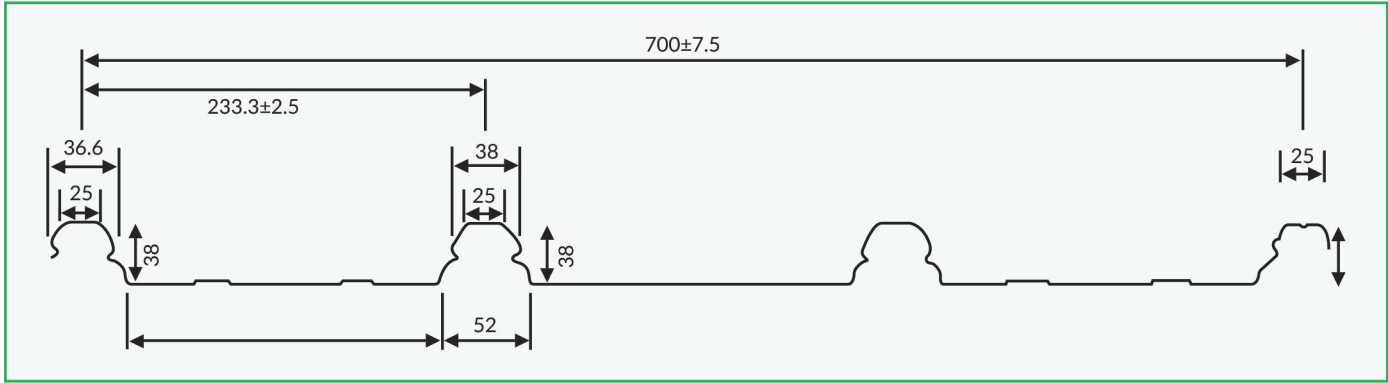

Specification

Steel Grade	Total Coated Thickness (mm)	Mass kg/m ²	Effective Coverage (mm)	Rib Height (mm)
G550	0.54	5.22	700	38
G550	0.48	4.61	700	38

Recommended Pitch

1° minimum

MAXIMUM RECOMMENDED SUPPORT SPACING

ROOF			WALL			Max Roof Overhang Unsupported (mm)
Single Span (mm)	End Span (mm)	Internal Span (mm)	Single Span (mm)	End Span (mm)	Internal Span (mm)	
1500	1650	2100	2300	2900	3100	250

BriSnap 2.0 Loading Table

Span (m)		1.2	1.6	1.8	2.1	2.4
Safe Distributed Load	kg/m²	560	360	240	180	140
Deflection Under Above Level	mm	4.0	6.0	9.0	12.0	16.0

TURN-UP EDGE

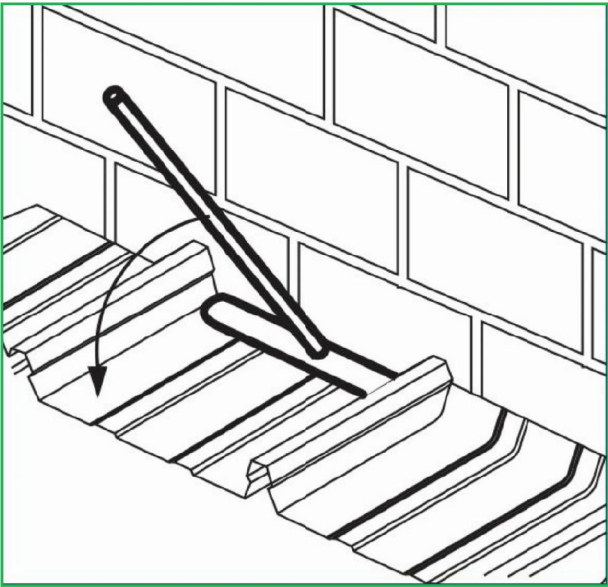

Irrespective of roof slopes, it is compulsory to turn up the edges of the sheets at the top end. This will act as a shield to any possible back splash of water into the building.

INSTALLATION METHOD

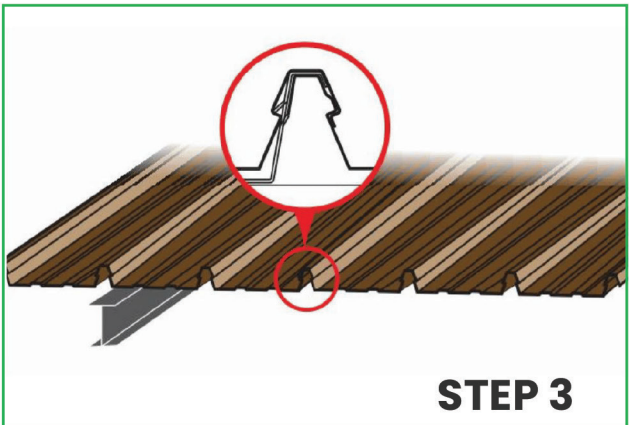
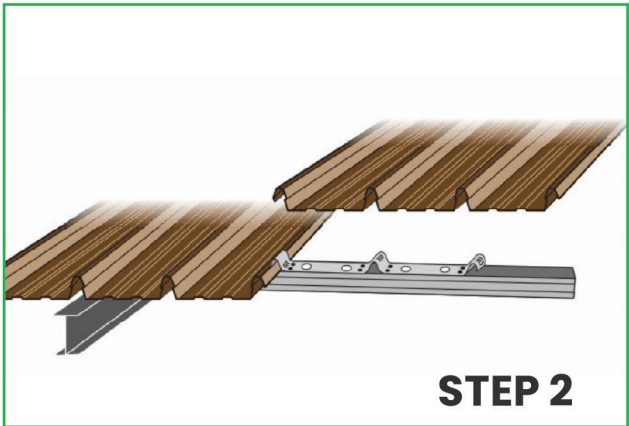
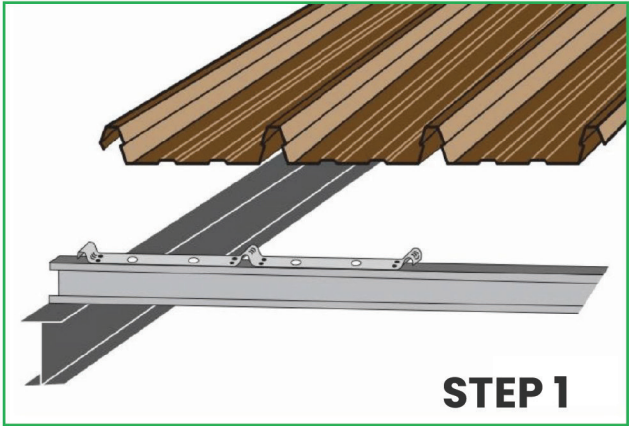

Engineered For Excellence, Built for Durability

We believe light steel construction is the future — engineered for speed, affordability, and reliability in every build.

BriSteel Corporation Sdn Bhd (182455-D)

 7A Lorong Anggur, Visa Industrial Estate,
Kolombong, 88450 Kota Kinabalu,
Sabah, Malaysia

 +6088-382 815/811

 +6088-382 813

 sales@bristeel.com

 www.bristeel.com